

1990-01 GSLSC Newsletter	2
1990-02 GSLSC Newsletter	4
1990-03 GSLSC Newsletter	6
1990-04 GSLSC Newsletter	8
1990-05 GSLSC Newsletter	10
1990-06 GSLSC Newsletter	12
1990-09 GSLSC Newsletter	14
1990-10 GSLSC Newsletter	16
1990-11 GSLSC Newsletter	18





BOURSES: Feb. 11 Drury Inn - Fenton  
Feb. 18 St. Aloysius Gonzaga  
Mar. 3-4, 1990 Northwest Plaza Spring Bourse

Member Profile: Ruthann Straight (membership #268) has been a member of the club for approximately 6 years and is just beginning a term as the club's Vice President. She is employed as a registered nurse for the St. Louis Public Schools and during the summer months serves as a staff nurse for the Bethesda Home. She is divorced, with two children and has been a resident of St. Louis all her life with the exception of the 4 years she spent at Depauw University in Greencastle, IN picking up a B.S. degree in Nursing.

Ruthann's collecting interests include foreign postal meters that she collects by country and type of impression and medical/pharmaceutical slogans on U.S. and foreign postal meters. She is just starting a topical collection of drugs and pharmacy on regular stamps.

In addition to our club, she is a member of the Mound City Stamp Club, the Webster Groves Stamp Club and Meter Stamp Society and can usually be seen at most of the area monthly bourses. She states, "I like stamps and the people who collect them."

Her one philatelic wish would be to obtain an updated Barfoot-Simon Meter Stamp Catalogue (after 1953) or if I can't have that, a complete set of back issues of Meter Stamp Society Bulletins.

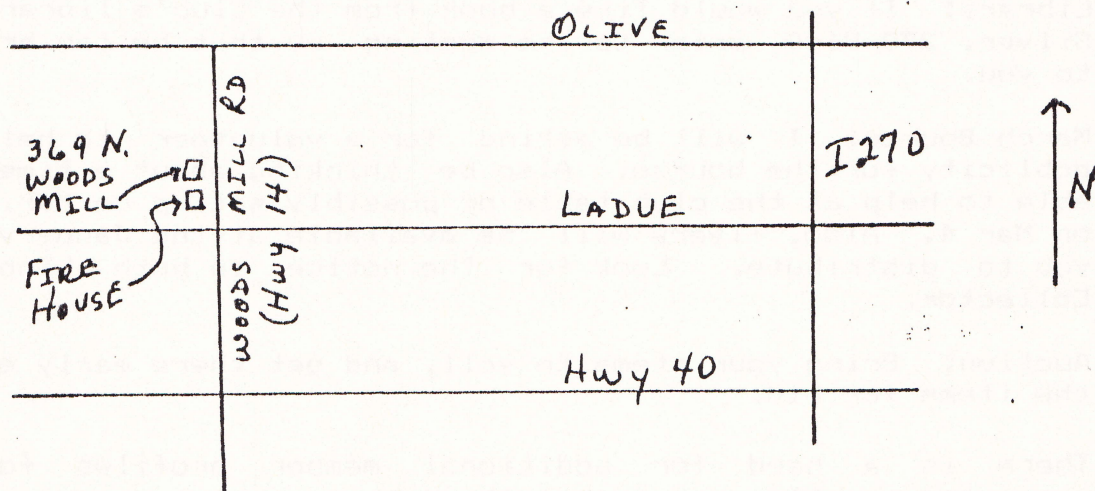

Directions: From the south cross Ladue Rd. and turn left at the light just north of the fire station. From the north go past the stadium and turn right at the light.

Park in the lot in front of the school. Enter the doors behind the flag pole and follow the signs around the cafeteria to room 303 which is next to the school store.







Bourse Profile: (The following was sent to the dealers coming to the bourse). Just a short note to let you know that all the pieces are coming together to make for an excellent bourse at the Northwest Plaza Auditorium on March 3 - 4, 1990. All 20 tables have been sold to local dealers and several out of town dealers. Over 2000 flyers have been distributed and over 1500 cards have been mailed to collectors within 125 miles of St. Louis. Linns and Stamp Collector have carried our bourse notice for 6 to 8 weeks and a news release will soon be going to area newspaper, radio, and TV people. About all that remains is for the people to turn out to look over and purchase the fine material that you are preparing to bring.

You may begin setting up your tables at 9:00 am on March 3. Coffee will be available at that time. We'll provide nametags for all of your table workers. I expect everything else to be the same as in the past. We'll have a club table to greet the visitors and register them for a door prize we'll draw for at 12:00, 2:00, and 4:00 each day. There will be special give-a-ways for the kids that attend. Payment for any remaining balance for your table(s) will be due by the end of the day on Sunday.

Below is the list of what I believe to be an outstanding group of dealers to revive the Northwest Plaza Bourse after an 18 month leave of absence. Here's hoping it is most successful to each of you.

H & T Stamps	Hal Lewis	Mascoutah, IL
Roger's Hobby Software	Roger Grider	St. Louis, MO
	Mike Landt	St. Louis, MO
Star Quality Co.	Nancy Moellering	St. Charles, MO
ASK Enterprises	Leon Jablonski	Houston, TX
Blue Valley Stamp Co.	Paul Oesterly	Kansas City, MO
G & L Stamps(2)	Bus Salomon	St. Louis, MO
JWF Stamps	James Farber	Bloomington, IN
(2)	Dick Lightle	Kansas City, MO
St. Ann Stamp Exchange	John Marquardt	Columbia, MO
Quality Stamps of S.L.	Ron McVay	St. Louis, MO
	Karen Moore	Hillsboro, MO
	Gene Stewart	St. Louis, MO
Stamp Corner(2)	Brad Salus	St. Louis, MO
J & J Stamps	Jack Young	Wichita, KS
Normandie Stamps	Richard Willmarth	Normal, IL
	Dennis Peoples	Indianapolis, IN

Plan to attend if at all possible to support these people.

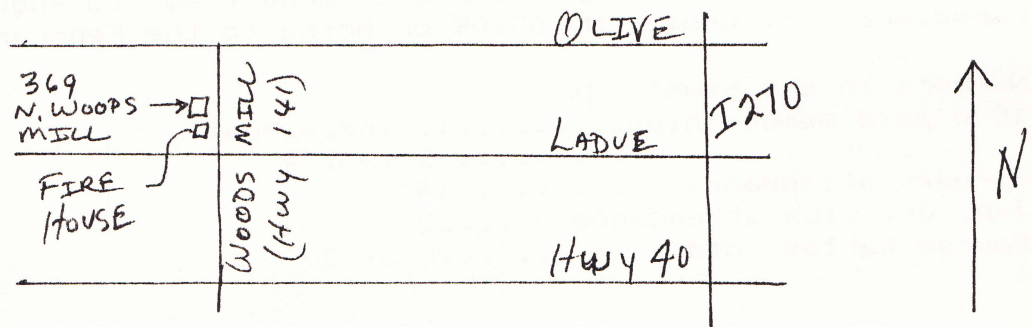

Directions: From the south cross Ladue Rd. and turn left at the light just north of the fire station. From the north go past the stadium and turn right at the light.

Park in the lot in front of the school. Enter the doors behind the playground and follow the signs around the cafeteria to room 303 which is next to the school store.







Bourses: Apr. 8 Drury Inn - Fenton  
 Apr. 22 St. Alousius Gonzaga  
 May 5-6 St. Charles Bourse - McKinley School  
 Jun. 23-4 MO Precancel Club 'Mulefest'

Member Profile: (none on file at this time)

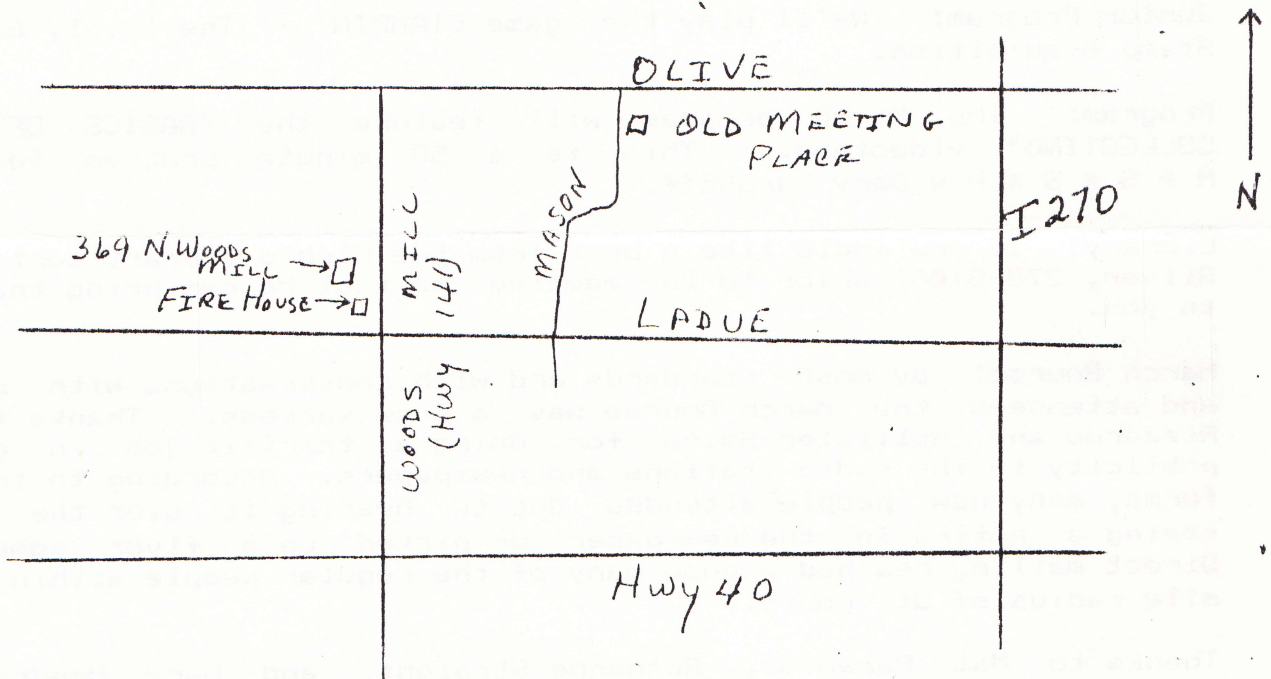

Directions: From the south cross Ladue Rd. and turn left at the light just north of the fire station. From the north go past the stadium and turn right at the light.

Park in the lot in front of the school. Enter the doors behind the flag pole and follow the signs around the cafeteria to room 303 which is next to the school store.







MEMBER PROFILE: (none of file at this time)

NEW ISSUE CALENDAR:

Apr. 18 \$.25 Marianne Moore commem. in Literary Arts Series  
Apr. 20 \$1.00 Seaplane in Transportation Series  
Apr. 26. \$.25 Lighthouses booklet of 5 commems.  
May 18 \$.25 Flag self-adhesive, ATM-compatible, sheet of 12  
Jun. 1 \$.25 Rhode Island Statehood Bicentennial commem.  
Jun. 2 \$2.00 Bobcat definitive

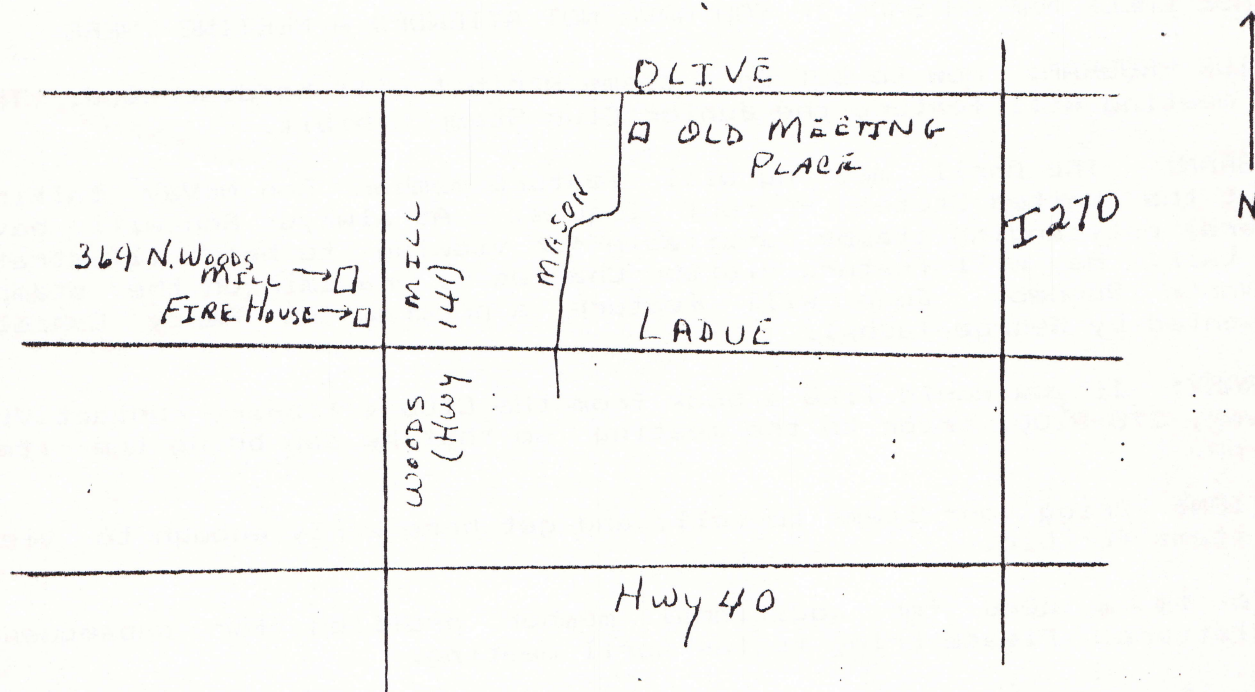

DIRECTIONS: From the south cross Ladue Rd. and turn left at the light just north of the fire station. From the north go past the stadium and turn right at the light.

Park in the lot in front of the school. Enter the doors behind the flag pole and follow the signs around the cafeteria to room 303 which is next to the school store.





## THE GREATER ST. LOUIS STAMP CLUB

Next meeting: May 29, 1990  
Place: Parkway Central High School  
Business Program: 8:00 p.m.  
Junior Club: 6:30 p.m.

PLEASE CHECK MAP ON BACK IF YOU HAVE NOT ATTENDED A MEETING THERE.

**JUNIOR PROGRAM:** The May meeting will feature the Junior Club Stamp Exhibit. All members are invited to arrive a little early to view the exhibits.

**JUNIOR AUCTION DONATIONS:** Anyone interested in donating an item or two for next month's Junior Las Vegas Auction, bring them to the May meeting. Most of the Juniors are U.S. collectors.

**PROGRAM:** May will feature visitor Charles L. Grassman on the stamps of North Borneo. June will feature a program on Croatia presented by George Taubel, a member of the German Philatelic Society. Thanks to Ron McVay for an excellent presentation last month on the U.S. 90 cent issues.

**NICKEL STAMP BOX:** Arrive early and spend some time picking through the newly added 5-cent box. Two to three pounds of recent foreign stamps on paper has been purchased for your browsing pleasure. Pick out as many as you want for your collection and reimburse the club's treasury at 5 cents per stamp. Looks like a good selection for starters.

**LIBRARY:** If you would like a book from the Club's library contact Vic Silver, 278-B100, prior to the meeting so that he can bring the item to you.

**AUCTION:** Bring your items to sell, and get here early enough to view the items for bid.

There is a need for additional member profiles for subsequent newsletters. Please bring to the May meeting.

**DUES:** This will be your last newsletter based on 1989 dues. Your 1990 membership fee is now overdue. If your mailing label has 89 under your membership number, you may have forgotten to renew your membership. \$5.00 for individual memberships or \$6.00 for family memberships. Make checks out to The Greater St. Louis Stamp Club and send them to Roger Grider, 6402 Lansdowne, St. Louis, MO 63109 or bring to the next meeting. If there is any discrepancy, please contact Roger before next month's mailing.

### NUMBERS IN THE NEWS:

1990 paid memberships.....	35 individual
.....	3 family
April attendance .....	20
April Jr. Club attendance .....	9



BOURSES: June 10 Drury Inn--Fenton  
 June 17 St. Aloysius Gonzaga  
 Jun. 23-4 MO Precancel Club "Mulefest"--Midway Motor Lodge

MEMBER PROFILE: (none of file at this time)

The item below is a reprint from Mekeel's Weekly-May 14, 1990



This is one of those in-between issues--with too many ads for 8 pages, but too few to cover the cost of 12 pages. There were extenuating circumstances, but there's no sense going on about it. I feel as uncomfortable as you do in these cramped quarters, especially as I get used to 12 pagers.

\*\*\*\*\*

Speaking of making do, I received a note recently from one of our many subscribers who have become friends. He indicated that he was going to give up the hobby, citing the high cost of collecting the many USPS new issues.

Why would someone totally abandon a hobby because he could not purchase mint stamps? Is there nothing else to collect? How about Precancels?

I cite Precancels because of a newsletter that recently crossed my desk. Collectors not familiar with Precancels may wonder what

## From The Editor's Desk

it is that causes others to "catch the bug." In addition to all the other attributes--thrill of the hunt, thousands of varieties within reach of the average collector, access to useful reference works, etc.--there also seems to be an unmatched camaraderie.

Gary Hendren, President of the Missouri Precancel Club expressed this in a past *Missouri Mule*, the newsletter of the Missouri Precancel Club:

"...Even though I have been a stamp collector for about forty years, I am a relative newcomer to precancels. Like many U.S. collectors, there comes a time when filling album spaces becomes expensive and a very slow process. It was a natural process to branch into other areas....

"I am grateful that someone pointed me in the direction of precancels and perfins. I joined the Precancel Stamp Society in

September of 1986, attended the Illini Precancel Stamp Club Spring Convention..., met so many movers and shakers of precancel-dom there who turned out to be such fine people, purchased a Bureau Album from George Klein, and an Illinois town and type collection from Phil Cayford, and I have been hooked ever since.

"Also in attendance at that meeting was a St. Louis contingent, all of whom have been a great help in getting me started on the right foot. By the time I left Indiana, I was an IPSC and a MPC member. Now I eagerly await the monthly-to-quarterly publications of a dozen or so precancel clubs.

"The thing that has impressed me most is the honesty, friendliness, and helpfulness of all I have made contact with. It is a refreshing experience I have not found in other philatelic organizations. I hope that never changes."

\*\*\*\*\*

Precancels are one option for collectors on a budget. So, don't give up. C'mon back next week.

*Y. F. Purn*

**YOURS FREE FOR  
THE ASKING**

**322nd Public Auction**  
 to be held  
**May 31 - June 1, 1990**  
 at the  
**Rasdale Auction Gallery**  
 United States & Foreign  
 sets - singles - collections  
 accumulations - wholesale







## THE GREATER ST. LOUIS STAMP CLUB

Next meeting: June 25, 1990  
Place: Parkway Central High School  
Business Program: 8:00 p.m.  
Junior Club: 6:30 p.m.

PLEASE CHECK MAP ON BACK IF YOU HAVE NOT ATTENDED A MEETING THERE.

**JUNIOR PROGRAM:** The June meeting will feature our Annual "Las Vegas" Auction. Each person will receive \$200 at the door. Don't forget to bring the money you have accumulated over the past year. Thanks to Joe Tucker, Ron McVay, Harry Lischer, and Gary Hendren for donations for the auction.

**PROGRAM:** June will feature a program on Croatia presented by George Taubel, a member of the German Philatelic Society. Ruthanne Straight will present the program in July entitled "Old Gold" - A look at European Meters. August will be "Show and Tell" month, so dust off an interesting item or two from your collection and tell the rest of us about it. Thanks to Charlie Grassman for an excellent presentation last month on North Borneo.

**NICKEL STAMP BOX:** Arrive early and spend some time picking through the newly added 5-cent box. Two to three pounds of recent foreign stamps on paper has been purchased for your browsing pleasure. Pick out as many as you want for your collection and reimburse the club's treasury at 5 cents per stamp. Looks like a good selection for starters.

**LIBRARY:** If you would like a book from the Club's library contact Vic Silver, 278-8100, prior to the meeting so that he can bring the item to you.

**AUCTION:** Bring your items to sell, and get here early enough to view the items for bid.

There is a need for additional member profiles for subsequent newsletters. Please bring to the June meeting.

**DUES:** If your mailing label has 89 under your membership number, you may have forgotten to renew your membership. \$5.00 for individual memberships or \$6.00 for family memberships. Make checks out to The Greater St. Louis Stamp Club and send them to Roger Grider, 6402 Lansdowne, St. Louis, MO 63109 or bring to the next meeting. If there is any discrepancy, please contact Roger before next month's mailing.



# NUMBERS IN THE NEWS:

1990 paid memberships.....36 individual  
 .....3 family  
 May attendance .....14  
 May Jr. Club attendance .....11

BOURSES June 23-4 MO Precancel Club "Mulefest"--Midway Motor Lodge  
 June 24 Stamp & Postcard Show - Ramada Inn, Fairview Hgts.  
 July 8 Drury Inn--Fenton  
 July 15 St. Aloysius Gonzaga

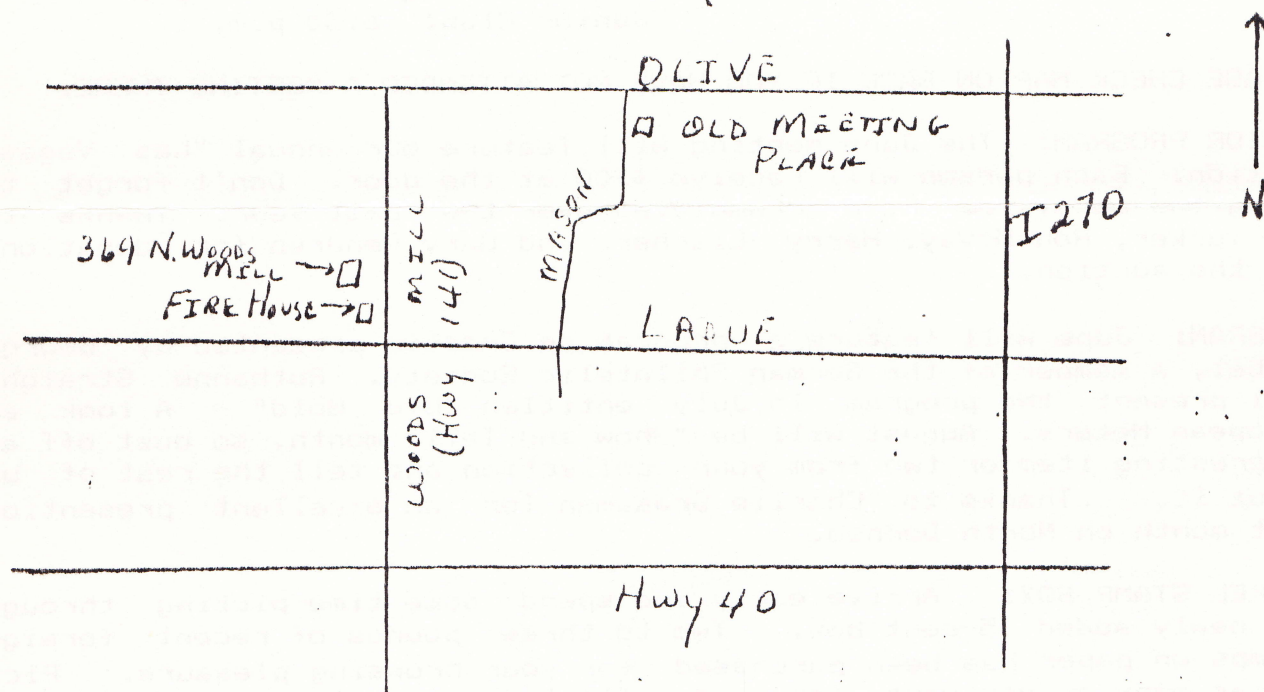

DIRECTIONS: From the south cross Ladue Rd. and turn left at the light just north of the fire station. From the north go past the stadium and turn right at the light.

Park in the lot in front of the school. Enter the doors behind the flag pole and follow the signs around the cafeteria to room 303 which is next to the school store.







Next meeting: Wednesday, 14, 1990  
Place: Parkway Central High School  
Business Program: 8:00 a.m.  
Lunch: 11:30 a.m.

PLEASE CHECK NOW ON BACK IF YOU HAVE NOT ATTENDED A MEETING THERE.

During previous years your Board's Liaison for some time in Texas work on identifying some of the reasons U.S. states are in the financial straits they are in. The program this month will be a historical review of the reasons why we are in this position. Thanks to someone special for her skills and program last month on Texas history.

Guest speaker: As this time there are about 10 dealers taking us 25 tables for the upcoming board. We will be a little crowded. Dealer's will be coming in from 20, 10, 10, and 10 in addition to many of our regular local dealers. I'm looking forward to an excellent time. The dealer list and their specialties will be available at the meeting.

Next staff box: Arrive early and spend some time picking through the newly added 2-cent box. Two to three pounds of recent foreign stamps on paper and paper purchased for your personal pleasure. But as many as you want for your collection and whatever the club treasury at 2 cents per stamp. Look like a good selection for next time.

Library: If you would like a book from the club's library contact the library, 120 West 10th St. for meeting, so that we can bring the book to you.

Activity: Bring your stamp to sell, and get here early enough to view the stamp for sale.

MEMBERS IN THE NEWS:

1990 paid membership: 1000  
Family: 1000  
Personal attendance: 1000  
And the club attendance: 1000

FORWARD: 500, 50-70, Northwest Plaza House  
Box 14, 1000, 1000  
Box 11, 1000, 1000  
Box 14, 1000, 1000





## THE GREATER ST. LOUIS STAMP CLUB

Next meeting: October 22, 1990  
Place: Parkway Central High School  
Business Program: 8:00 p.m.

PLEASE CHECK MAP ON BACK IF YOU HAVE NOT ATTENDED A MEETING THERE.

JUNIOR PROGRAM: No program this month.

PROGRAM: Roger Edwards will give the October program on "World War II Collectibles." Winners of last month's Stamp Trivia Contest were Ron McVay, Roger Edwards, and Jerry Walterscheid.

BOURSE UPDATE: There were 21 dealers taking up 27 tables for the September bourse. Dealers hailed from SD, IL, IN, IA, and TX in addition to many of our regular local dealers. There were over 300 people in attendance for the two day show.

NICKEL STAMP BOX: Arrive early and spend some time picking through the newly added 5-cent box. Two to three pounds of recent foreign stamps on paper has been purchased for your browsing pleasure. Pick out as many as you want for your collection and reimburse the club's treasury at 5 cents per stamp. Looks like a good selection for starters.

LIBRARY: If you would like a book from the Club's library contact Vic Silver, 278-8100, prior to the meeting so that he can bring the item to you.

AUCTION: Bring your items to sell, and get here early enough to view the items for bid.

### NUMBERS IN THE NEWS:

1990 paid memberships.....40 individual  
.....3 family  
September attendance .....17  
Sept. Jr. Club attendance .....12

BOURSES      Oct. 21      St. Aloysius Gonzaga  
              Nov. 3-4    St. Charles Bourse  
              Nov. 11    Drury Inn  
              Nov. 17    St. Aloysius Gonzaga

OCT 26-28 MIDAPHEL - K.C.

(OVER)



**BASICS OF STAMP COLLECTING COURSE:** If you are new to stamp collecting, starting again after a period of inactivity, feel the need to brush up on the basics of stamp collecting, or just want to know more about the hobby, this course is for you. Among the topics to be covered are the basic terms of the hobby, sorting, soaking, and mounting stamps in an album, proper use of the perforation gauge and watermark detector, use of catalogs, albums, sources of stamps, and philatelic organizations and literature. A trip to a philatelic center and stamp bourse are included. Gary Hendren will teach this 5 night course for the Ferguson-Florissant Community School Program starting after January 1, 1991.

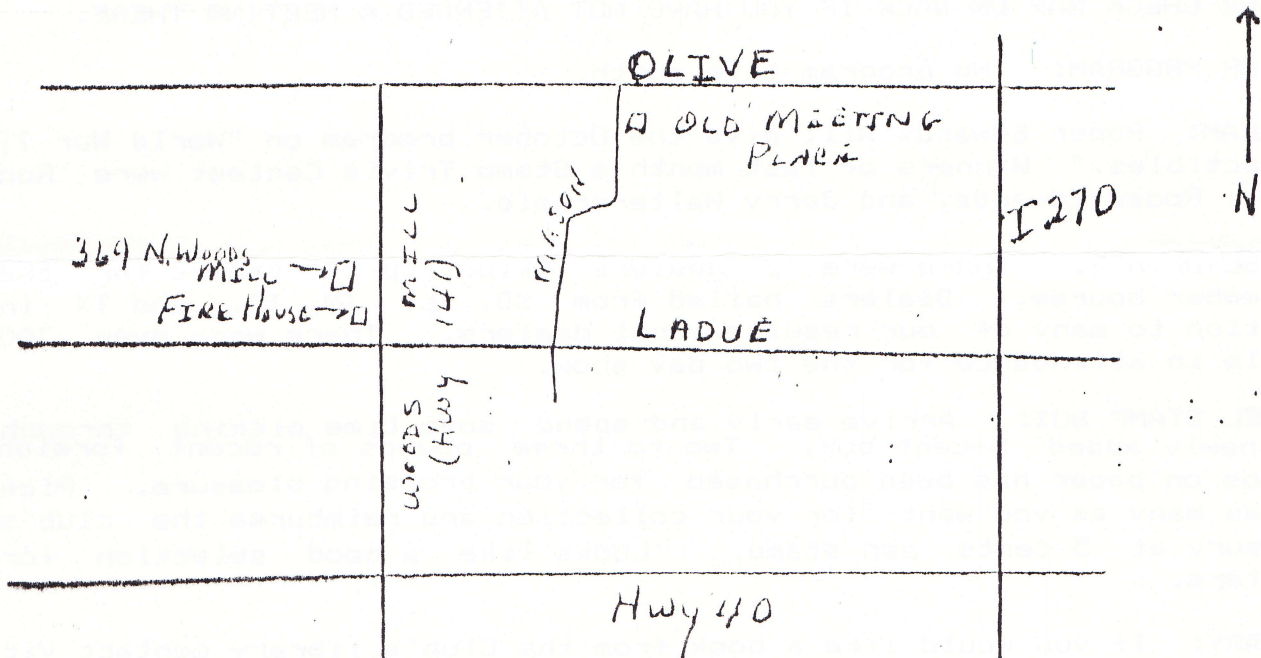

**DIRECTIONS:** From the south cross Ladue Rd. and turn left at the light just north of the fire station. From the north go past the stadium and turn right at the light.

Park in the lot in front of the school. Enter the doors behind the flag pole and follow the signs around the cafeteria to room 303 which is next to the school store.

# DEC 12 - CHRISTMAS DINNER





**BASICS OF STAMP COLLECTING COURSE:** If you are new to stamp collecting, starting again after a period of inactivity, feel the need to brush up on the basics of stamp collecting, or just want to know more about the hobby, this course is for you. Among the topics to be covered are the basic terms of the hobby, sorting, soaking, and mounting stamps in an album, proper use of the perforation gauge and watermark detector, use of catalogs, albums, sources of stamps, and philatelic organizations and literature. A trip to a philatelic center and stamp bourse are included. Gary Hendren will teach this 5 night course for the Ferguson-Florissant Community School Program starting after January 1, 1991.

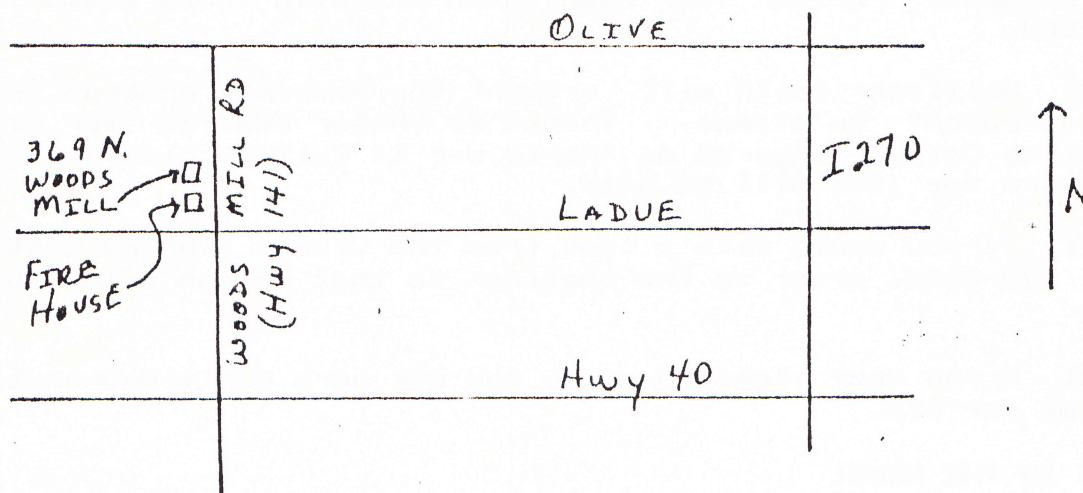

**DIRECTIONS:** From the south cross Ladue Rd. and turn left at the light just north of the fire station. From the north go past the stadium and turn right at the light.

Park in the lot in front of the school. Enter the doors behind the flag pole and follow the signs around the cafeteria to room 303 which is next to the school store.